



Independent Play Park Inspections 2019 Moderate Risk (or higher) Issues

Kingshill Play Park -

12 - Moderate Risk	
Item: Multi Play (Junior) Manufacturer: Playdale Playgrounds Ltd Surface Type: Grass Matrix Tiles Equipment Compliance: Yes Surface Area Compliance: Yes	
Total Findings: 5	
Finding 1 There are areas or parts of the timber on the structure that have rotted (1 of 8 posts) - Replace all affected timbers	Finding 2 There is some evidence of fire damage to the item - Monitor for any further deterioration and repair as required
Finding 3 The rope has broken and there are sharp wire strands protruding - Replace rope or net	Finding 4 There is some graffiti present - Remove the graffiti
Finding 5 There is/are bolt cap covers missing or damaged on the item - Replace missing or damaged bolt cap covers	

PLEASE NOTE: Findings 1 & 3 are the Moderate Risk Items.

War Memorial Recreation Ground -

12 - Moderate Risk	
Item: Multi Play (Toddler) Manufacturer: Wicksteed Playgrounds Surface Type: Wet Pour Equipment Compliance: No Surface Area Compliance: Yes	
Total Findings: 7	
Finding 1 There is/are several inserts missing - Replace missing inserts	Finding 2 The plywood has delaminated in some places - Remove all rough or splintered edges.
Finding 3 There are areas or parts of the timber on the structure that have rotted - Replace all affected timbers	Finding 4 The safety surface under or around this unit has been damaged - Monitor for any further deterioration and repair as required
Finding 5 The item fails to meet the requirements of BS EN 1176 Part 1 4.2.7.2 head and neck entrapment in the barriers and/or steps - Monitor - No remedial work recommended	Finding 6 Parts of the timber are rough or splintered - Remove all rough or sharp edges
Finding 7 There is some graffiti present - Remove the graffiti	

PLEASE NOTE: Finding 3 is the moderate Risk Item

Highfields Play Area -

12 - Moderate Risk	
Item: Log Climber Manufacturer: Playdale Playgrounds Ltd Surface Type: Grass Matrix Tiles Equipment Compliance: No Surface Area Compliance: Yes	
Total Findings: 4	
Finding 1 There is some strimmer / machinery damage apparent on the posts, this can penetrate the preservative applied to the timber and accelerate the rotting process - Monitor for any deterioration (rot) and replace as required	Finding 2 The ropes/nets are worn/damaged in places - Monitor for any further deterioration and repair or replace as required
Finding 3 There are areas or parts of the timber on the structure that have rotted (2 of 7 posts) - Replace all affected timbers	Finding 4 There are falls in excess of 600mm between adjacent components on the structure, in contravention of the recommendations set out in BS EN 1176 Part 1; 4.2.8.4 - Monitor - No remedial work recommended

PLEASE NOTE: Finding 3 is the Moderate Risk Item.

12 - Moderate Risk	
Item: 1 Bay 2 Seat (Flat) Manufacturer: Wicksteed Playgrounds Surface Type: Wet Pour Equipment Compliance: No Surface Area Compliance: Yes	
Total Findings: 7	
Finding 1 The seat is severely damaged and requires replacing - Replace damaged seat	Finding 2 The chain openings are in excess of the 8.6mm as recommended by BS EN 1176 - Monitor - No remedial work recommended
Finding 3 There is some notable evidence of chain wear - Monitor for any further deterioration and replace when 40% worn	Finding 4 The swing seat connectors are loose - Tighten to secure
Finding 5 The seats are too close to each other as defined in BS EN 1176 Part 2; this is a low risk failure and no remedial action is required - Monitor - No remedial work recommended	Finding 6 The bushes are showing signs of wear - Monitor for any further deterioration and replace as required
Finding 7 The safety surface under or around this unit has been damaged - Monitor for any further deterioration and repair as required	

PLEASE NOTE: Finding 1 is the Moderate Risk Item.

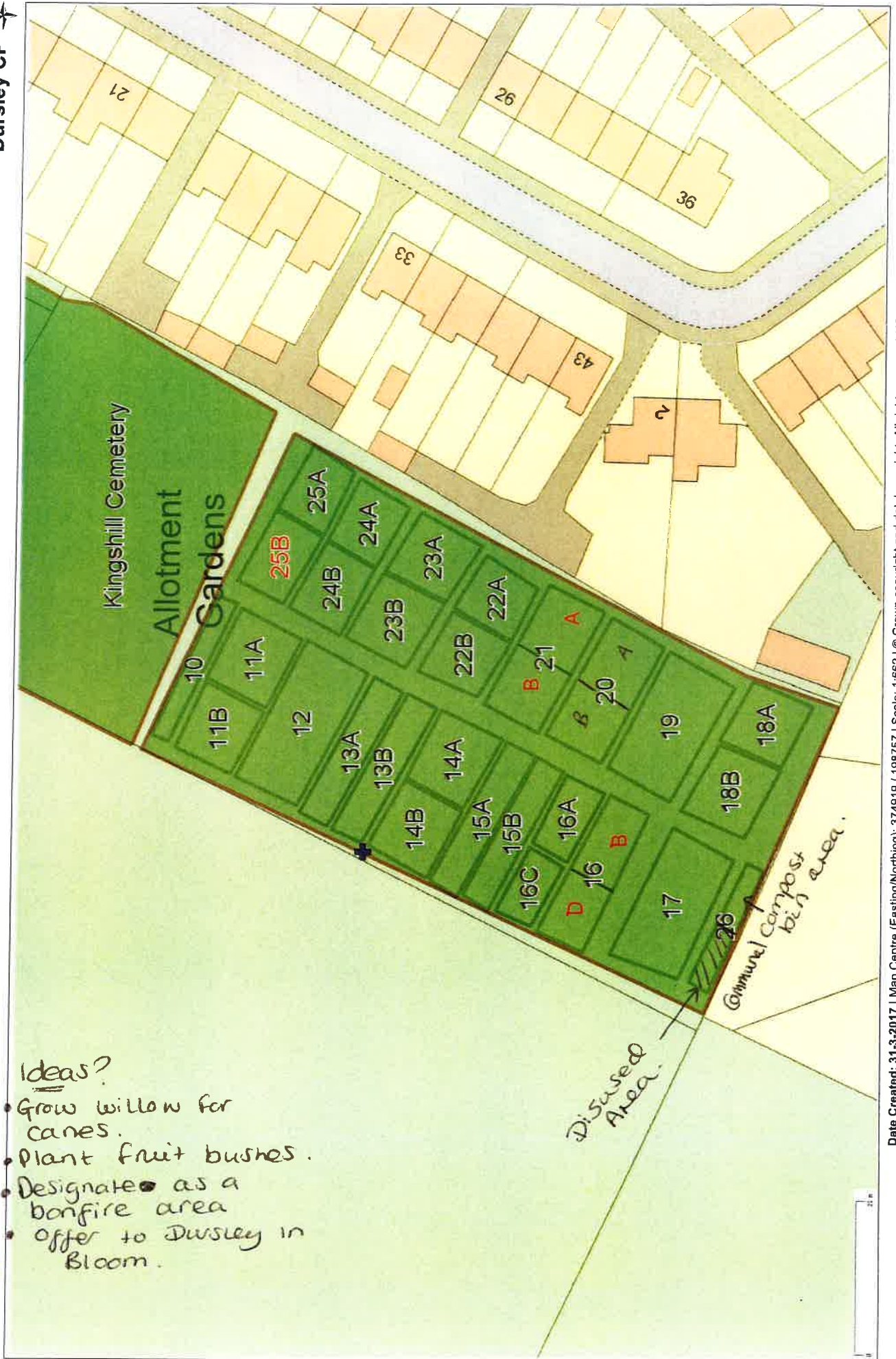

- Ideas?
- Grow willow for canes.
 - Plant fruit bushes.
 - Designate as a bonfire area
 - offer to Dursley in Bloom.

Disused Area.

Compost bin area.

