

BUS STATION BENCHES X 2.

BCPL 27/07/2019.

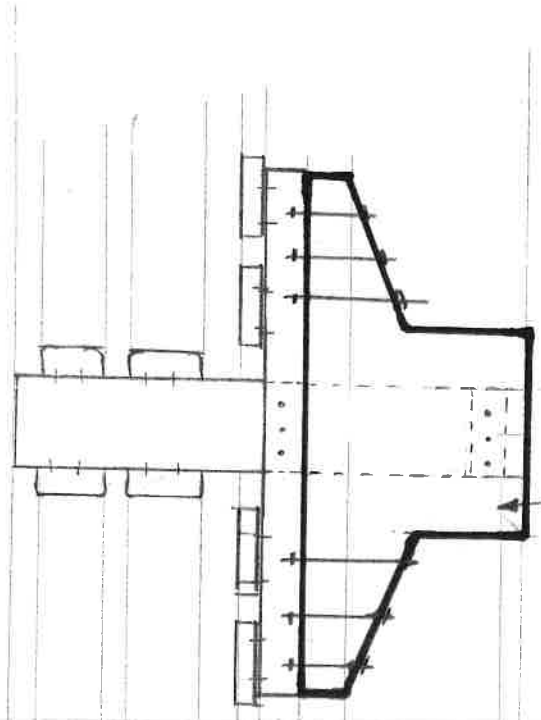
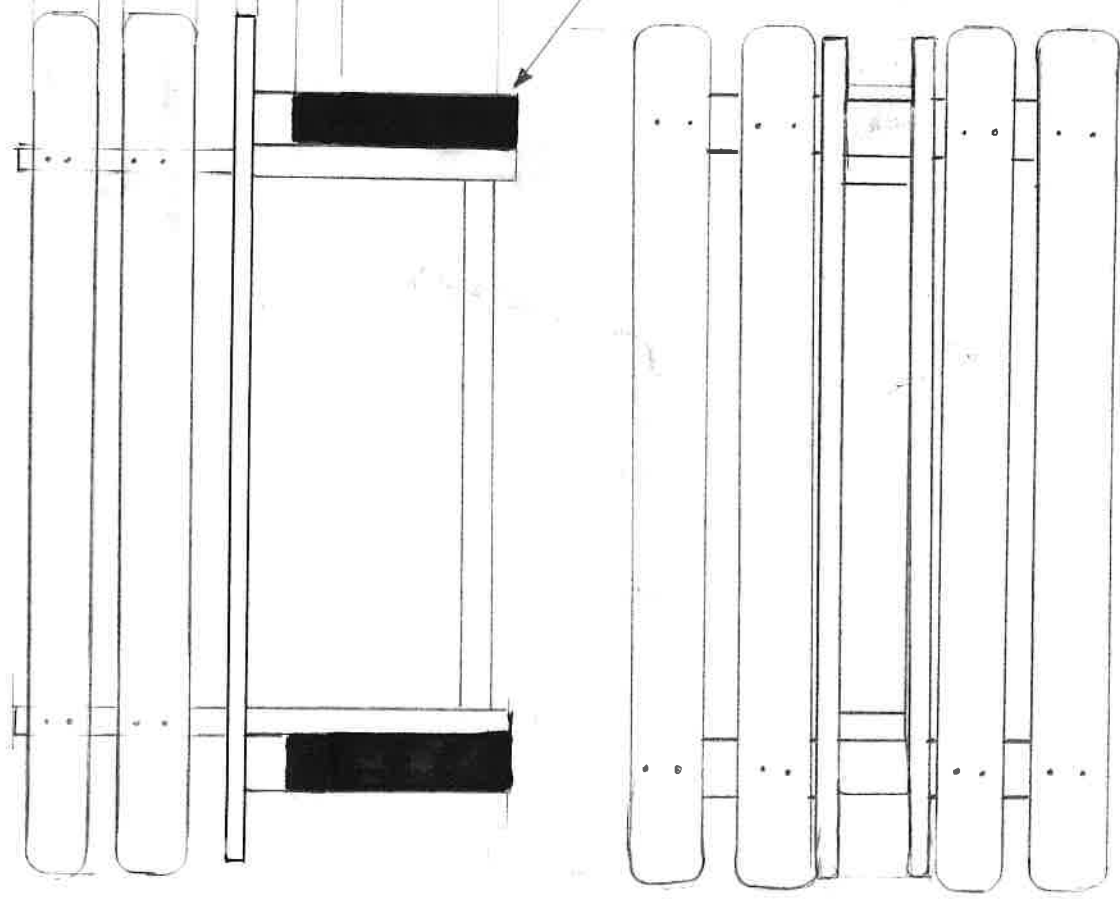

WORK INCLUDES

REMOVAL OF ALL OLD SEAT WOOD +
 FININGS, CLEAN CONCRETE,
 PROVIDE MATERIALS + CONSTRUCT 2 + SEATS.

ORIGINAL CONCRETE

ALL NEW TREATED WOOD + FININGS

TOTAL SUGGESTED DONATION

HISTORY - 9 APRIL 2019. TOWN IMPROVEMENTS 8) PAPER .

Bus Station Seating

The seating comprises of concrete legs with bolted wooden slates. It is B1 on our asset register.

The seating is not currently failing to the point it needs to be removed, but the wooden slates are in need of refurbishment/maintenance if it is to last. Size of each bench – approx. 95cmx213cm.



Options

Repair/Refurbish

Ground staff have looked at the benches and it would be difficult to refurbish them due to the fixings. The bolts are very old and rounded off in some cases. Those located on the middle bench slats are not easy to access, there is no access to them underneath the concrete base so it is likely they will break when removed. Any damage that occurs during the removal of the bolts may prevent us installing new ones into the concrete bases, we won't know until we try.

Remove and do not replace

The benches are popular, people sit waiting for buses here when the weather is good enough. When I visited on 1st April I counted at least 8 people sitting on them wait for buses. When asked about the seating a group of 5 commented that the "seating was fine but it would be nice to have back rests".

Replace with new seating

Pictures just give an idea of what's available on the market should a replacement be the preferred option (note: prices are just a guide, there may be additional costs e.g. delivery/fixing kits).



Plaza III S bench Broxap, with or without backrest (£2,476.00 with BR)
Length: 1200mm Width: 1200mm Height: 450mm Weight: 145.5 kg.



£1,665.00 Helston Broxap



£996 Beckford Seat Broxap

TOWN IMPROV"
CTEE
LIKED
BECKFORD
SEAT
- 9/4/19.



£952.00 Tiptree Bench Broxap



Waybridge Broxap



£1,723.00 Helston Straight Bench Broxap



Eastthorpe Broxap (POA)



EH Steel Bench Anti-Vandal David Ogilvie
1800mm length £693 /2000mm length £811.

Price for a bolt down kit to secure the bench to a hard standing is £9.50. Delivery £105.



Anti-Vandal KC Steel Bench Seat David Ogilvie
POA



Sheldon bench Langley



Langley bench

**DURSLEY TOWN COUNCIL
TOWN IMPROVEMENTS- PROPOSED BUDGET 2019/20 TO 2021/22**

Town Improvements Expenditure

Code	Title	Previous 2018/19		Current			Proposed		
		Budget	Final	Budget	Actual*	Expected	2020/21 Budget	2021/22 Budget	2022/23 Budget
410	Maint - Street Furniture/Bus Shelters	500	439	1000	287	1000	1000	1000	1000
412	Plants and planters	1000	895	1500	399	1500	1500	1500	1500
460	Christmas lights	6500	7156	6500	990	6500	7000	7000	7000
461	Christmas Light - CTR	0	0	2500	0	2500	2500	2500	2500
480	New - Street furniture/Bus Shelters	1000	222	1000	99	1000	1000	1000	1000
491	Tourism	2000	0	2000	0	2000	2000	2000	2000
500	CCTV	3000	10247	3000	0	3000	3000	3000	3000
912	Notice Boards	0	0	1500	0	1500	1500	1500	1500
TOTAL		24000	18959	19000	1775	19000	19500	19500	19500

*Actual at 26/09/2019

Town Improvements - Projects 2019/22

Town Improvements	Code	2019/20	2020/21	2021/22	2022/23	Total 3 Year Expenditure	Use of reserves	Reserve	3 Year Budget/ Precept
Castle Street Upgrade	470	0	2440	0	0	2440	2440	TCUF	0
CCTV (New system)	500	0	0	0	0	0	0	GENERAL	0
Creation of Visitor Information Centre	491	2000	2000	2000	2000	6000	6000	0	6000
Total		2000	4440	2000	2000	8440	2440		6000

Note

Dursley Town Council - Reserves

Named Reserve	Responsible Committee	Confirmed Balance at 31/3/19	Transfers during 2019/20	Balance at 31/3/20 (PROPOSED)	Notes
Town Centre Upgrade Fund	TI	2440	0	2440	
Christmas Lights	TI	2957	0	2957	
War Memorials	TI	1000	0	1000	
Tourism	TI	2000	-2000	4000	SDC Grant Received 24th April
Tourism (ex - Dursley & District Tourism Association Funds)	TI	0	-625	625	Closure of an old bank account - to be held for Cotswold Edge & Severn Vale Tourism Group
Total Town Improvements				£ 11,022	
Facilities Improvements	GS	4103	0	4103	
Cemetery Extension	GS	16000	0	16000	
Additional Allotments	GS	20000	0	20000	
Repainting Fund	GS	1500	0	1500	
Noticeboards, bins	GS	2796	0	2796	
Trees/tree work	GS	536	0	536	
Machinery/Vehicle Fund	GS	10000	3666	6334	Purchase of Mower (April 2019)
Play areas/equipment	GS	0	2000	-2000	Contribution to reserve from 2019/20 budget
Highfields Play Equipment Upgrade	GS	25430	0	25430	
Tennis Court (S106/Grant)	GS	1834	0	1834	
Total Green Spaces				£ 76,533	
IT support/hardware	Policy & Finance	0	0	0	
Temporary Staff	Policy & Finance	1,000	0	1000	
Jacobs House	Policy & Finance	3,584	0	3584	
H&S Audit	Policy & Finance	3,000	0	3000	
Election costs	Policy & Finance	3,000	0	3000	
Youth Centre Reward Fund	Policy & Finance	1,120	0	1120	
Community Infrastructure Levy (CIL)	Policy & Finance	0	-531	531	New Reserve Created - allocation of CIL funds received in 2018/19 (9/4/19) and 2019/20 (2/5/19)
Total Policy & Finance				£ 12,235.31	
Car Park	Car Park Committee	28,746	28746	0	Funds allocated in 2019/20
Total Car Park				£ -	
Total Earmarked Reserves		£ 131,046		£ 99,791	