

NOTES:

ALL TRAFFIC MANAGEMENT TO BE IN ACCORDANCE WITH CHAPTER 8 OF THE TRAFFIC SIGNS MANUAL AND THE TSRGD 2002, AND INSTALLATION, MAINTENANCE AND DISMANTLE METHODS MUST COMPLY WITH HEADWAY TRAFFIC MANAGEMENT'S RELEVANT METHOD STATEMENT(S).

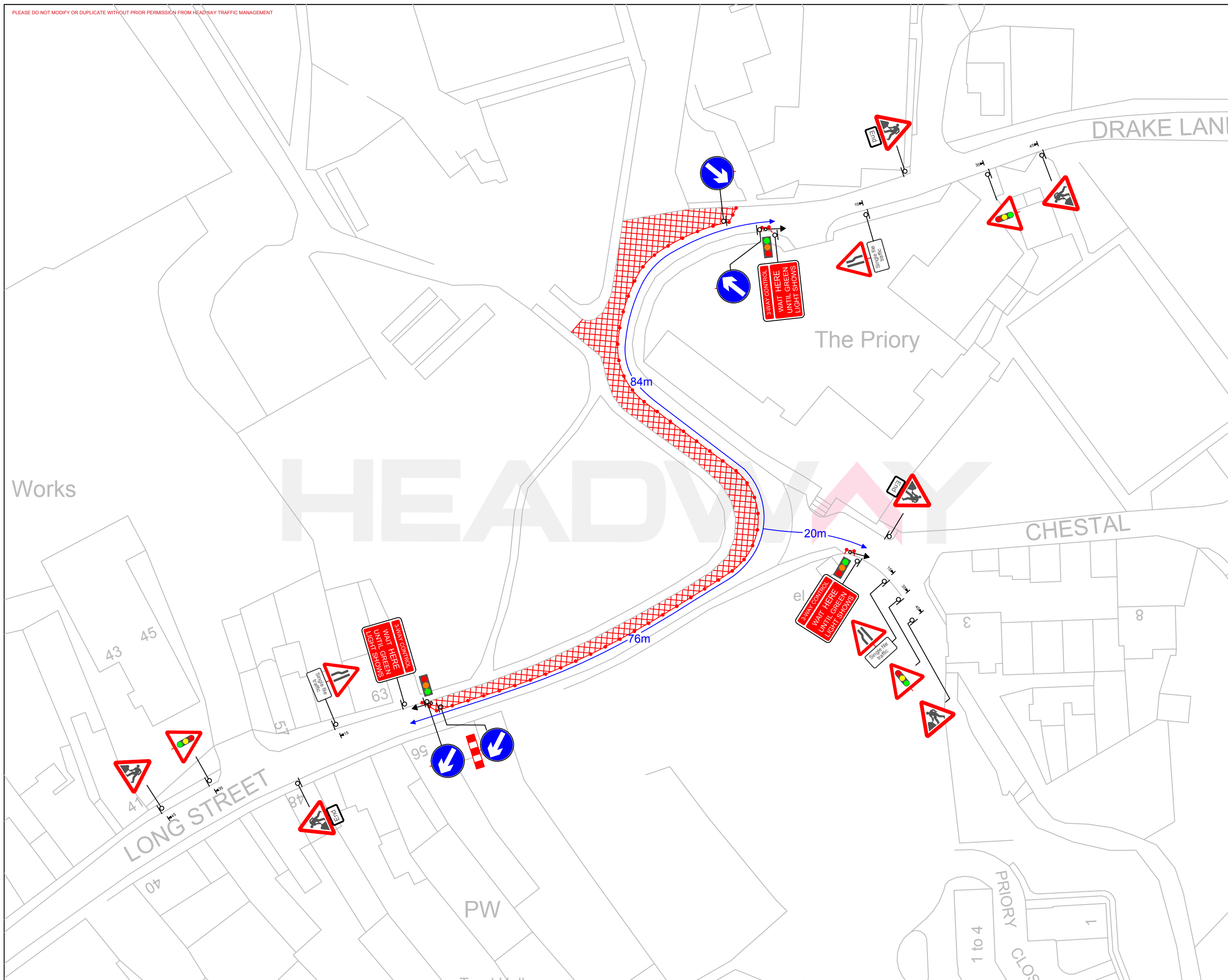

**HEADWAY**  
TRAFFIC MANAGEMENT

**M. V. KELLY LTD**

PROJECT:

**3 Way Lights**

SITE ADDRESS:

**Long Street,  
Dursley,  
GL11 4HR**

DRAWN BY: <b>L.Satchwell</b>	DATE: <b>31/05/2018</b>
CHECKED BY: <b>C.Moran</b>	OUR REF: <b>1</b>
REF: <b>*****</b>	REVISION: <b>1</b>